

At **Prime Texas Surveys**
we are ready
to handle all of your
surveying needs.

Call **Us** for
more information and
an estimate on your
next project

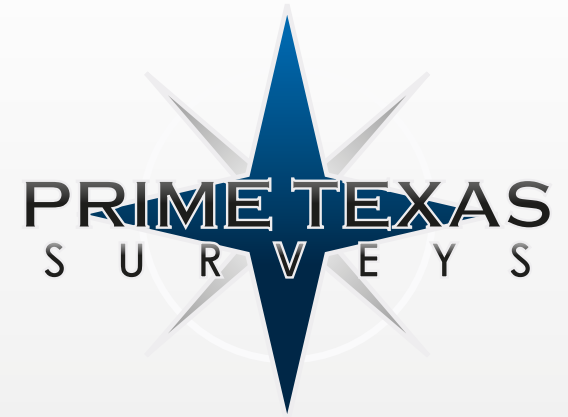

- ✦ Title Survey
- ✦ Acreage and lot survey
- ✦ Commercial ALTA/ACSM Title Survey
- ✦ Elevation Certificates
- ✦ Engineering Surveys
- ✦ Topographical and Utilities Surveys

We survey Houston and surrounding counties
Harris, Montgomery, Fort Bend, Galveston and
Brazoria

Also Austin and surrounding counties
Travis, Burnett, Bastrop, Williamson, Caldwell

We also offer a full spectrum of Builder & Architect
Services. We strive to provide the best possible
land survey service with the most competitive prices
on all your land surveying needs.

P: 713.864.2400

F: 713.869.1008

Email: orders@primetxsurveys.com

Over 25 years total experience in the land
surveying profession. Experienced in a
wide range of projects from Residential to
Commercial Surveys, Highway Preliminary
Design Surveys, Route Surveys/Pipeline
and Telecom Fiber Optic to Mortgage
Surveys along with Mining Surveys.

2417 North Freeway Houston, Texas 77009

License #10133000

www.primetxsurveys.com

Our goal is to be your company's number one choice for all your land surveying needs. We can provide you with land surveying services in a timely and accurate manner while staying cost effective.

Residential / Category 1-a Title Surveys

Boundary locations, ownership lines, rights-of-ways and easements within or immediate surrounding subject lot, parcel or quantity of real estate

Acreage and Lot Survey

If your property consist of a single lot, a few lots combined, a few acres, or thousands of acres; Prime Texas Surveys experienced staff and advanced technological equipment can handle all of your lot survey needs accurately and efficiently

Commercial: ALTA/ACSM Title Survey

An ALTA survey is the most detailed survey that can be done by a surveyor. The ALTA survey requires a higher standard of accuracy and is done so that a title company can insure the title to land without exceptions. This requires that the surveyor be provided with all of the appropriate data which can be relied upon in the preparation of the survey

Elevation Certificates

If any portion of your property is located in the FEMA flood Hazard Area, This certificate will specify whether the actual structure is above or below the FEMA's base Flood Elevation (Flood Zone). Lenders may require flood Hazard Insurance and Certificate. Insurance Agencies may require the certificate to determine Flood Hazard Insurance Premiums

Topographical Surveys

Surveys that show all the physical features of a tract of land. When contours are shown it allows the user to calculate drainage and/or run-off of the site. These surveys are normally used by engineers, architects and managers to plan for areas of future development

Engineering Surveys

Engineering surveys are surveys that are requested by engineering companies as a prerequisite to preparing plans for some type of improvement project. This could include property surveys, elevation profiles, and a topographical survey for new sewer lines, topographic surveys that include contouring for airports, highways, and new plant sites of any kind

Utility Surveys

Surveys that identify all underground utilities, including water lines, waste water lines, storm lines, gas, cable, telephone and electrical lines

Builder and Architect Services

Surveying to layout on the ground improvements that are shown on a set of construction plans. This could include staking of building corners, staking the location and elevation of a new underground utilities, staking the location and elevation of any concrete to be poured (roads, driveways, etc). These surveys are normally required by engineers, architects, construction companies and developers. We specialize in land planning for residential and commercial platting